

DYNAMIC 17

CREW BOAT
34M / 226 GRT



TECHNICAL SPECIFICATION

Principal Particulars

Flag	: Panama
Class	: Bureau Veritas; Fast Crew Boat CAT-A
Year Built	: 2009
L.O.A	: 34.00 M
Length Registered	: 31.93 M
Breadth Moulded	: 7.86 M
Depth Moulded	: 3.34 M
Draft Moulded	: 1.50 M
Summer Freeboard	: 2.035 M
GRT	: 226 MT
NRT	: 67 MT
Deadweight	: 44 MT
Clear Deck Area	: 80 m ²

Performance

Maximum Speed	: 22 knots
Economical Speed	: 18 knots
Type of Fuel	: Marine Diesel Oil

Capacities

Passenger Seats	: 50 - 60 person
Accommodation	: 8 nos. for Crew
Hospital	: 2 nos.

*All Cabins are fully air-conditioned

Navigation & Communication Equipment

VHF Radio	: 2 x T&T
-----------	-----------

Machineries

Main Engine	: 3 x 1450 BHP @ 2300 rpm Caterpillar C32
Main Generator	: 2 x 75 kW Cummins 6 CTA 8.3
Bow Thruster	: 1 x 1000 kgs Thrust
Steering Gear	: 1 x Kobelt 7175MA (electro hydraulic)
Propulsion System	: 3 x 5 Bladed FPP of Nickel Aluminium Bronze
Rudders	: 2 nos.

Cargo Capacities

Fuel Oil	: 46 MT
Fresh Water	: 20 MT
Sludge Tank	: 250 Ltrs
Dispersant Tank	: 200 Ltrs
Deck Cargo	: +/- 40 MT
Deck Strength	: 2.5 Tonnes/m ²
Cargo Railing Height	: 1.118 M

PUMP DISCHARGE CAPACITY

Fuel	: 3m ³ /hr at 22m head
Fresh Water	: 2m ³ /hr at 22m head

Deck Equipment

Anchor Winch	: Electrical single drum and warping head 1 ton nominal pull at 9m/min
--------------	--



Handheld VHF Radio	: 3 x 2.5 w, I.S type c/w spare battery and charger	Anchors	: High Holding Power Type, 1 x 135 kgs. (approx.)
Radar No.1	: Furuno MU-201CR/008241	Chains	: 4 x 100mm dia. Double-bit
Radar No.2	: Furuno Model-1715	Bollards	: 2 x 100mm dia. Single bit
Echo Sounder	: 1 x Skipper ED165	Mooring Chocks	: 4
Magnetic Compass	: 1 x Richie		
Gyro Compass	: 1 x ANSCHUTZ 80109		
Gyro Repeater	: 1 x ANSCHUTZ STD 22		
Auto Pilot	: 1 x ANSCHUTZ Nauto Pilot NP 60		
AIS	: 1 x Furuno FA-1502 14313		
Speed & Distance Log	: 1 x Furuno DS-80		
BNWAS	: 1 x BWAS-2000, BN2-M 14020222		
SSB Radiotelephone	: 1 x Furuno FS1575T/3592-0755		
Navtex	: 1 x Furuno DS-810/9154		
GMDSS	: 1 set T&T		
Inmarsat-C	: 1 x Furuno		
SART	: 2 x SafeSea S100-UK		
EPIRB	: 1 x MCMurdo E-5		
Rudder Indicator	: 1 x Kobelt 7175-M4		
Bow Thruster Control	: 1 x HRP TTCS41M		
Anenometer	: 1 x Walker 10937		
Barometer	: 1 x Barigo		
Hygrometer	: 1 no.		

LIFE SAVING APPLIANCES

Life Jackets	: 63 nos.
Liferafts	: 6 x 25 pax SOLAS Viking
Life buoys	: 8 nos.
Work Vest	: 8 nos.
EEBD	: 2 nos.
Rescue Stretcher	: 2 nos.
Self Breathing App.	: 2 nos.
Line Throwing App.	: 4 set
Parachute Flare	: 12 nos.
Hand Flare	: 6 nos.
Orange Smoke Signal	: 2 nos.
MOB Smoke Signal	: 2 nos.
Rescue Boat	: 1 x 6 person Inflatable with 25hp outboard motor & launching davit

FIRE FIGHTING EQUIPMENT

Fire Monitor	: 2 x fitted on the PS and STBD Side aft of main deck
Fire Pump	: 300m ³ /hr (Volvo Penta Stand-alone unit)
Fixed CO2 System	: 1 x Aerosol Fire Suppression System
Emergency Fire Pump	: 1 x Diesel Driven 30m ³ /hr portable type
Fireman's Outfit	: 2 x complete w/ breathing device
Fire Blanket	: 3 nos.
Fire Fighting Ext.	: 15 nos.

AXILIARY SYSTEM

Rescue Zone	: Port & Starboard at Main Deck
Oily Water Separator	: 1 x 0.5 T/hr
Sewage Treatment Plant	: 1 x ISS-15 Make: IL Seung Co., LTD.

DYNAMIC 17

PRINCIPAL DIMENSIONS

LENGTH O.A. (Hull) _____ 34.00 M
 LENGTH W.L. _____ 31.87 M
 BREADTH MLD _____ 7.85 M
 DEPTH MLD _____ 3.30 M
 DRAFT (Miscorp) _____ 1.50 M

COMPLEMENT _____ 10 CREW
 _____ 50 PERSONNEL

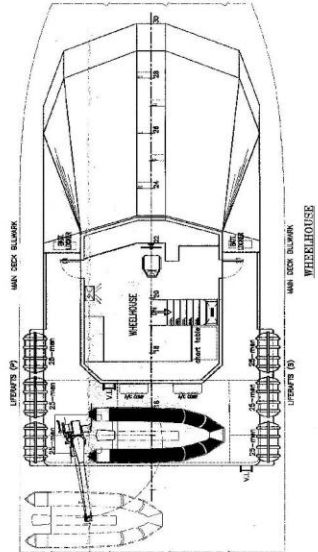
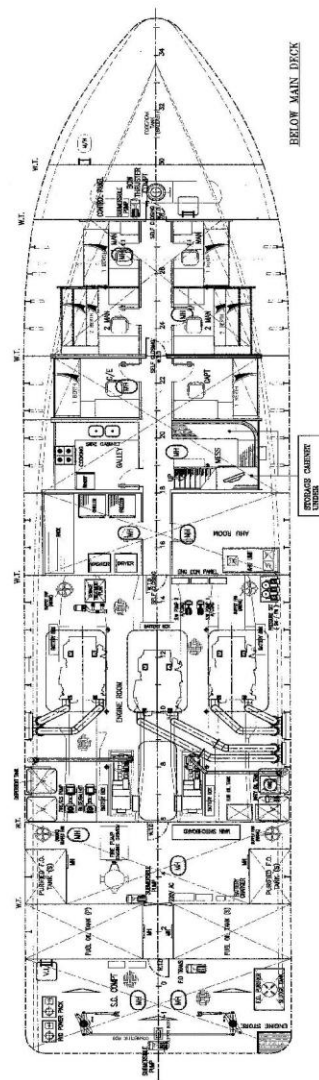
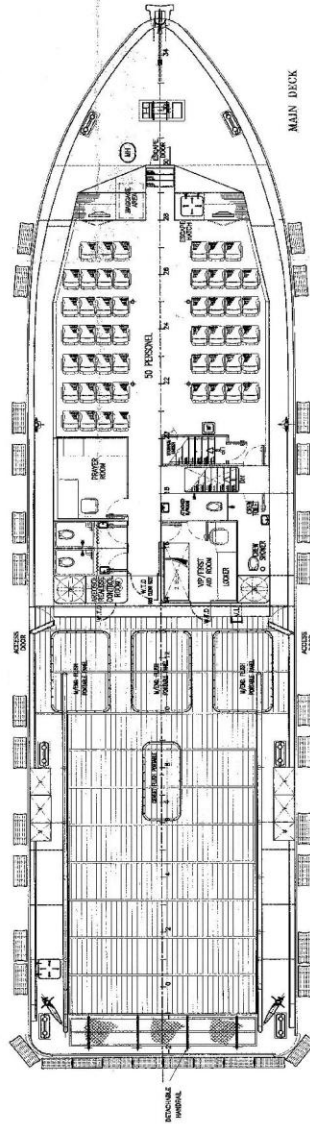
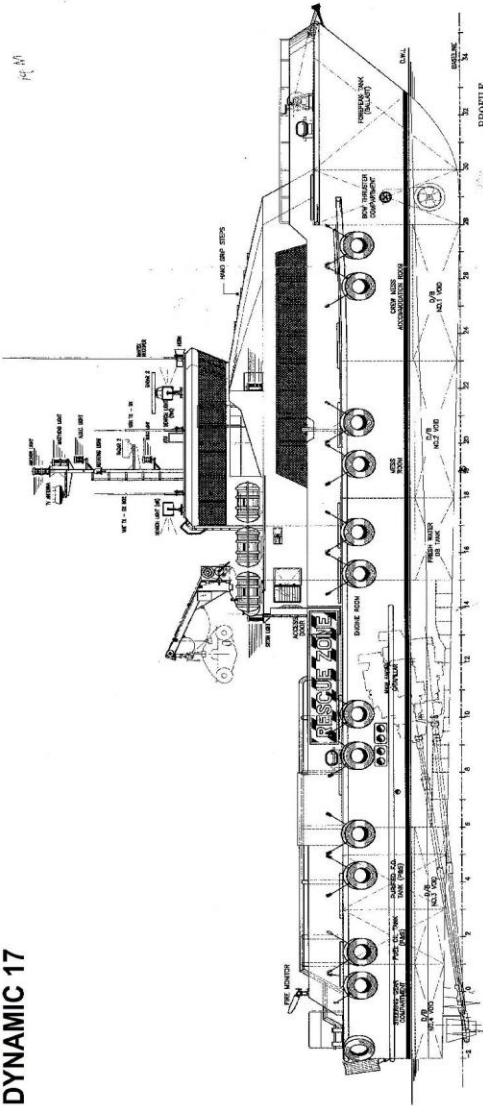

NGV TECH EQUIPMENT
AS BUILT

No.	REV.	DATE	
NGV TECH SDN BHD (230605) SD E-mail: ngvtech@dynamicmarine.net Tel: 833-788217			
PROJECT: 34M EAST OFFSHORE CREWBOAT TITLE: GENERAL ARRANGEMENT			
DRAWING NO: 1184		SCALE: 1:75	
DRAWN: J. LIM		CHECKED: J. LIM	
DATE: 25.08.08		NO: C-01	
PROJECT: 1184		SHEET 1 OF 1	